

	Robot model	Controller	Controlled axes	Max. load capacity at wrist [kg]	Repeatability [mm]	Mechanical weight [kg]	Reach [mm]	Motion range [°]						Maximum speed [°/s]						J4 Moment [Nm]/ Inertia [kgm ²]	J5 Moment [Nm]/ Inertia [kgm ²]	J6 Moment [Nm]/ Inertia [kgm ²]	IP Rating
								J1	J2	J3	J4	J5	J6	J1	J2	J3	J4	J5	J6				
Paint Mate	PaintMate 200iA	R-30iA Mate	6	5	± 0.02	35	704	340/360	200	388	380	240	720	350	350	400	450	450	720	11.9/0.3	11.9/0.3	6.7/0.1	ATEX certification, cat II 2G + 2D
	PaintMate 200iA/5L		6	5	± 0.03	37	892	340/360	230	373	380	240	720	270	270	270	450	450	720	11.9/0.3	11.9/0.3	6.7/0.1	

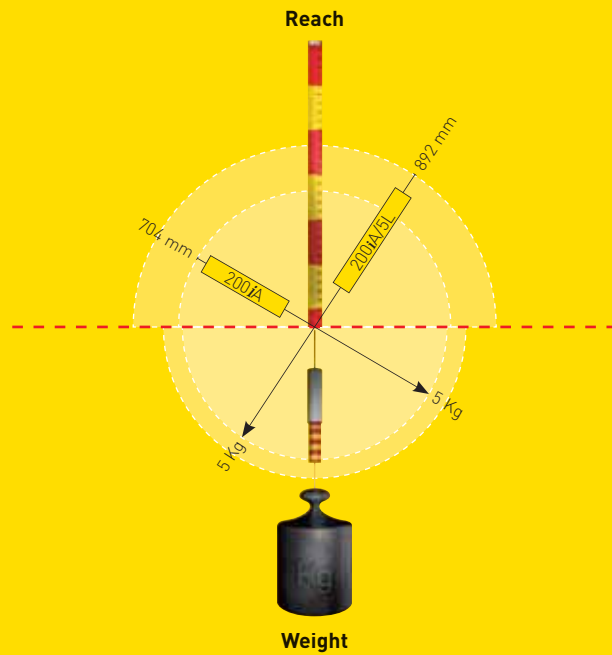

- The following Paint Mate robots models are available:
- Paint Mate 200iA with 5kg payload and 704 mm reach
 - Paint Mate 200iA/5L with 5kg payload and 892 mm reach

THE FANUC PAINT MATE ROBOTS ARE SUITABLE FOR A WIDE RANGE OF PAINTING AND COATING APPLICATIONS. THEIR COMPACT SIZE, HIGH AXES SPEEDS AND HIGH PAYLOAD ALLOW TO AUTOMATE SMALL PARTS AND MANUAL PAINTING AND ACHIEVE BEST PRODUCTION RATES AND QUALITY FOR ALL SORTS OF MATERIALS SUCH AS PLASTICS, METAL, WOOD...

FEATURES AND BENEFITS

FANUC Paint Mate robots are ideal for many types of materials and applications:

- Automotive components (e.g. mirrors, motor cycle tanks)
- Plastics and rubber (e.g. mobile phone, helmets)
- Wood and furniture (e.g. windows)
- Steel and fabrication products
- Consumer good (e.g. TV sets, household ovens)
- Anti-corrosion
- ... and many other

ALUMINUM LIGHT WEIGHT ARM FOR PAINTING

- Aluminum construction
- Requires less power for operation, hence reduced power consumption costs
- Enhanced security: no risk of ignition source in case of collision
- Easy cleaning
- Waterproof
- Smooth exterior surface to minimise contamination

COMPACT ARM AND SLIM WRIST FOR TIGHTEST PAINT BOOTHS

- With the lowest body mass, smallest footprint in its class the Paint Mate robots are ideal for tightest paint booths.
- The slim and strong wrist can reach into narrow spaces and work pieces, while 5kg payload capacity is sufficient to hold special and double guns.

EXTERNAL CABLE MOUNTING

Colour and air hose cables are fixed externally to the J3 and J2 arm.

- No restriction in the work envelope
- Greater security thanks to cable fixing
- Hoses are kept away from the wrist, which keeps the work piece clean

COMMON DESIGN DIRECTION AND COMPONENTS

- EX proven mechanical unit is achieved by purging the whole cavity of the robot - standard FANUC motors can be used
- As reliable and dynamic as all other FANUC robots
- Standard gears, motors and reducers as used in all FANUC robots with direct motor coupling, hence same well appreciated reliability
- Proven FANUC robot controller
- Same program structure as FANUC non-painting robots
- Ease of programming

DEDICATED AND POWERFUL APPLICATION SOFTWARE = LR PAINTTOOL

LR PaintTool offers advanced process functions:

- Process orientated operating
- Saving time for setting of process parameter setting
- Process specific terminology
- Atomising and fan air calibrated units
- 40 Presets by Color
- "Hot Edit:" editing of paint parameters and motion points during production
- Easy set-up of line tracking programs (See chapter Application Tools)

FLOOR, CEILING, WALL AND ANGLE MOUNT

- The Paint Mate robots can easily be mounted above the work piece.
- Robot can be mounted on the floor and on the ceiling without any restrictions.
- Ceiling mounted robots provide easier access to machine being serviced and part load/unload area.
- When wall mounted the Paint Mate robots can even process work pieces as long as 1100mm and 1400mm.

ATEX APPROVED

Robot is entirely ATEX certified (explosion proof).

- Category 2
- Group IIG (previously zone 1) and Group IID

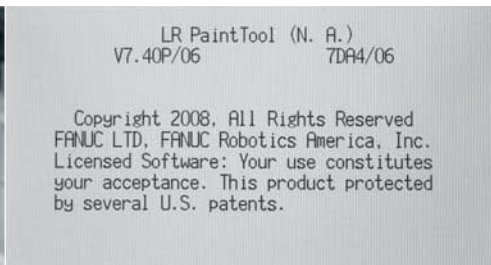

Paint Mate 200iA/5L

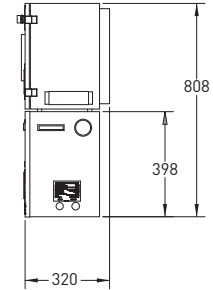
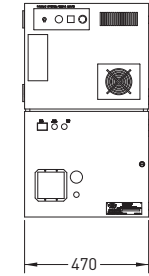
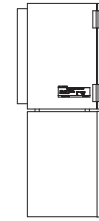
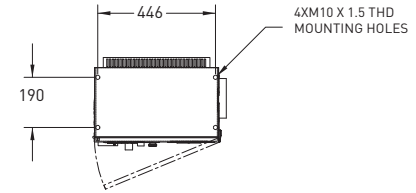
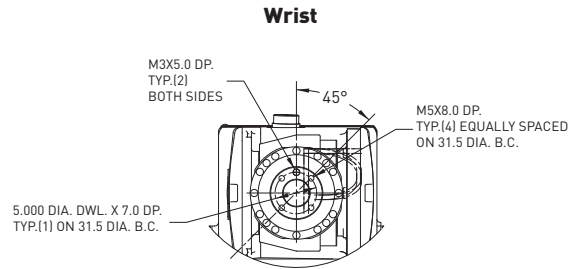
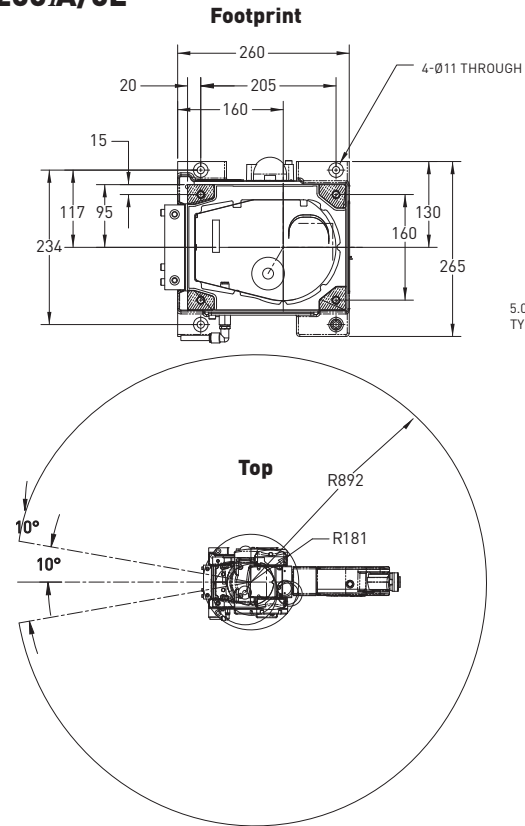

R-30A MATE CONTROL CABINET

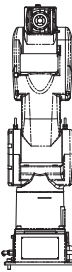
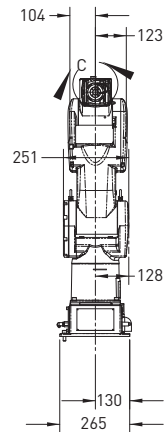
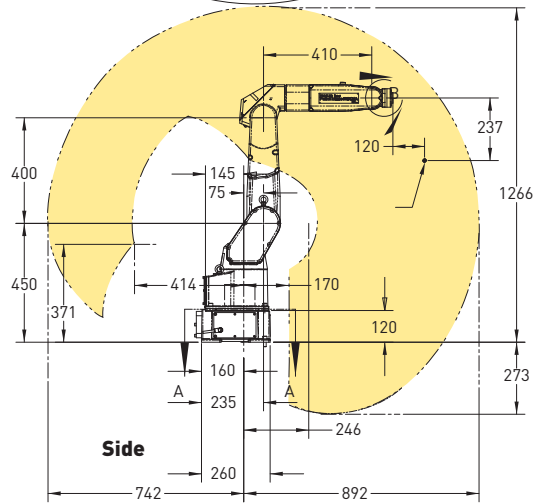
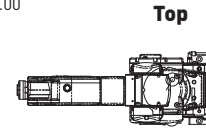
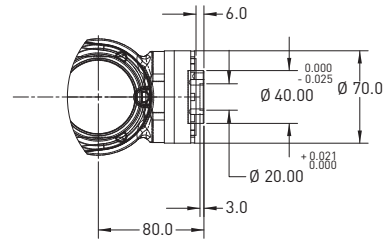

Front

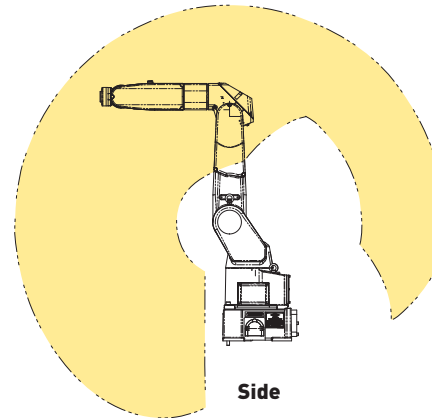

Side

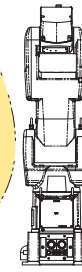

Back

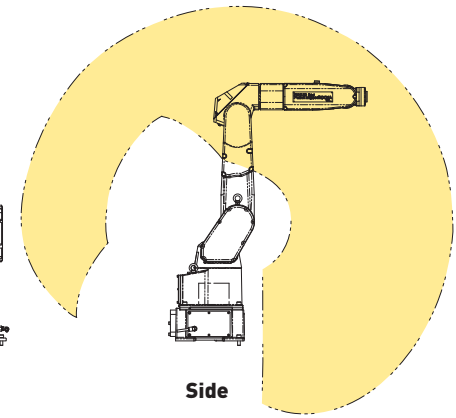

Side